

Glass breakage sensor

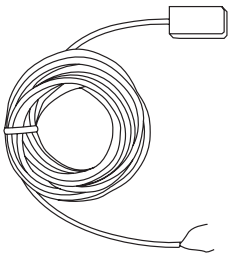

Colour	Article no.
polar white	663192
brown	663193

Table of Contents

1.	Function	1
2.	Installation	1
3.	Technical Data	2

1. Function

The glass breakage sensor monitors even glass surfaces within a max. radius of 2 m. The sensor evaluates ultrasonic signals that are typically produced when glass is broken or damaged for frequency and amplitude. In the event of glass breakage, the sensor opens for approx. 0.5 to 5 seconds, depending on the type of glass. The connection to the INSTABUS EIB is carried out via the binary input, flush-mounted/4x10 (art. no. 639898). It is possible to connect up to 15 sensors in series in one zone.

2. Installation

Glass breakage sensors may only be mounted on correctly cleaned surfaces using the prescribed adhesive. If other adhesives are used, hairline cracks can develop unnoticed for example and trigger false alarms.

Therefore:

- Use the appropriate glass breakage sensor for connection to EIB binary inputs: (art. no. 663192) or (art. no. 663193).
- Note the distances from the window specified in the installation instructions.

For a horizontal installation, a distance of at least 20 mm downwards from the frame is stipulated while it is possible to install the device flush with the frame if mounting sideways to the frame (0-20 mm distance).

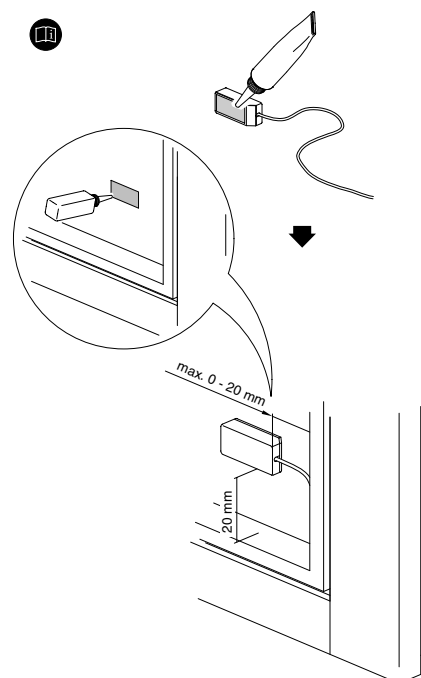

- For cleaning purposes, a grease-free cleaning agent should be used (e.g. pure alcohol).
- Only use the **adhesive Loctite no. 15168 or Loctite no. 19382**. Note the instructions for use of these two compound adhesives.
- Glass breakage sensors are suitable for installation on flat double panes (installation on single panes is also possible in exceptional circumstances).
- Glass breakage sensors may not be used on domed panes (e.g. bullseye glass), laminated glass or panes protected with alarm wires or foil.

Distribution board, surface-mounted/flush-mounted

The distribution board, surface-mounted (art. no. 669192 in polar white) or distribution board, flush-mounted (art. no. 669092 in polar white) can be used for connection of up to 15 sensors to an input of the binary input, flush-mounted/4x10.

Surface-mounted installation

Flush-mounted installation

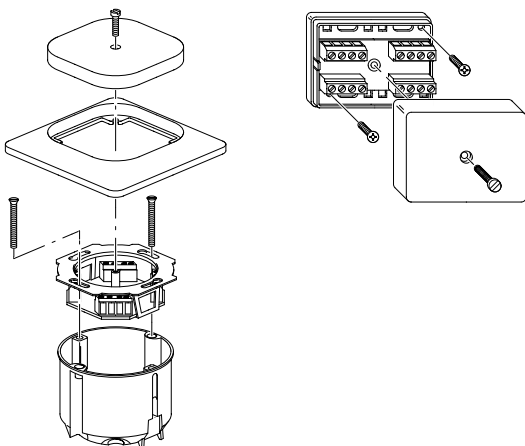

The distribution boards, surface-mounted/flush-mounted have 16 screw connections. The maximum conductor cross-section is 2.5 mm². The maximum conductor cross-section on the binary input, flush-mounted/4x10 is 1.0 mm². Two cores with up to 1.0 mm² per screw terminal can be mounted on the distribution board without any problems. A total of up to 15 sensors can be connected in series to a distribution board (cable: at least 2-core control cable, one twisted core pair recommended).

3. Technical Data

Contact type:	1-pole make contact
Line voltage:	max. DC 18 V
Idle current:	max. 10 mA
Switching capacity:	max. 350 mW
Alarm duration:	0.5 ... 5 s (depending on the glass breakage noise)
Effective radius:	2 m
Adhesive:	Loctite no. 15168 or Loctite no. 19382
Connecting cable:	5 m LiYY 2x0.14 mm ²
Temperature range:	-30 °C to +70 °C
Type of protection:	VdS environmental class IV, IP 67
Dimensions:	37x19x12 mm