

merten

ARGUS rookmelder 230 V
Detector de fumo ARGUS 230 V

Art.-Nr. 5475xx

ARGUS rookmelder Connect 230 V
Detector de fumo ARGUS Connect 230 V

Art.-Nr. 5485xx



Overzicht / Sinopse

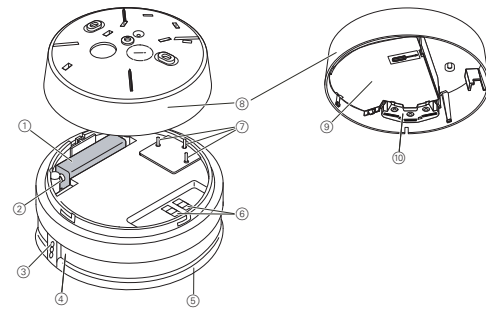

- 1 Batterij/ Pilha
- 2 Batterijaansluiting/ Conexão da pilha
- 3 LED's (rood/groen), testknop / LEDs (vermelho/verde), botão de teste
- 4 Opleeningen voor sirene/ Aberturas para sirene
- 5 Rookmelder/ Detector de fumo
- 6 Schakelaar voor verbinding met RF / Interruptor para Schalter para interligação rádio
- 7 Aansluitpennen voor 230 V-netwerkklem / Pinos de conexão para terminal de rede de 230 V
- 8 Sokkel / Base
- 9 Afdekking kabel aansluiting / Tampa da conexão do cabo
- 10 230 V-netwerkklem / 230 V, terminal de rede

Montage / Montagem

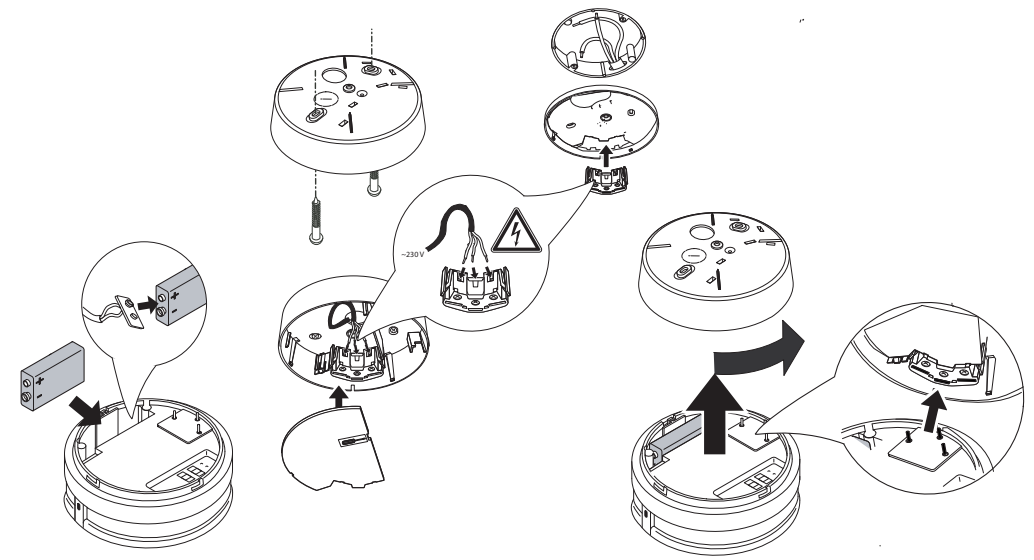

Signalen / Sinais

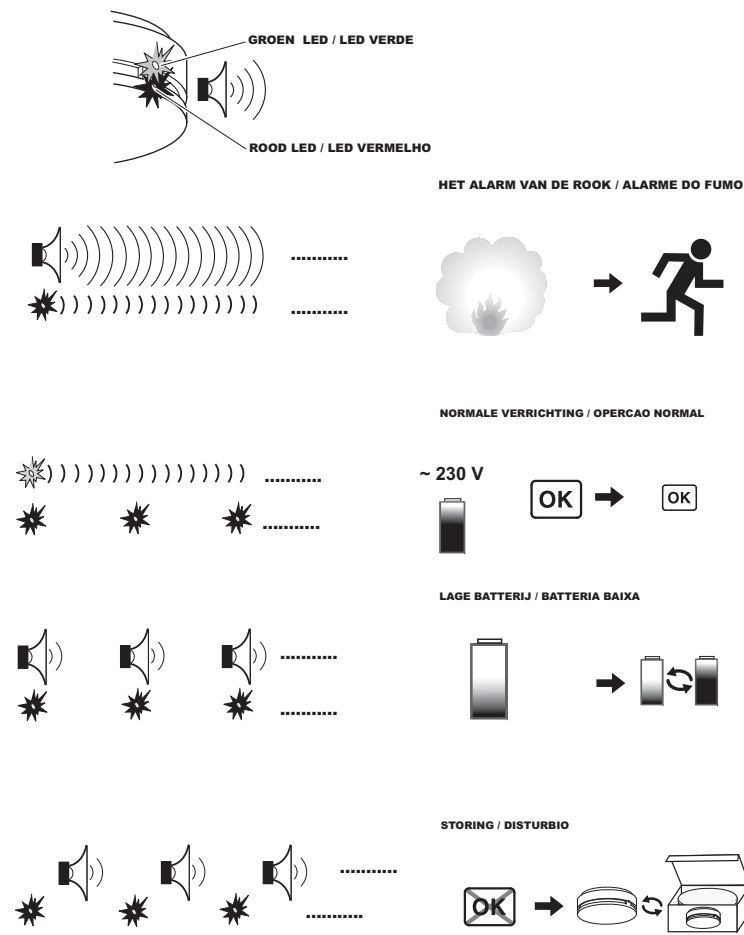

Montageplaatsen / Locais de montagem

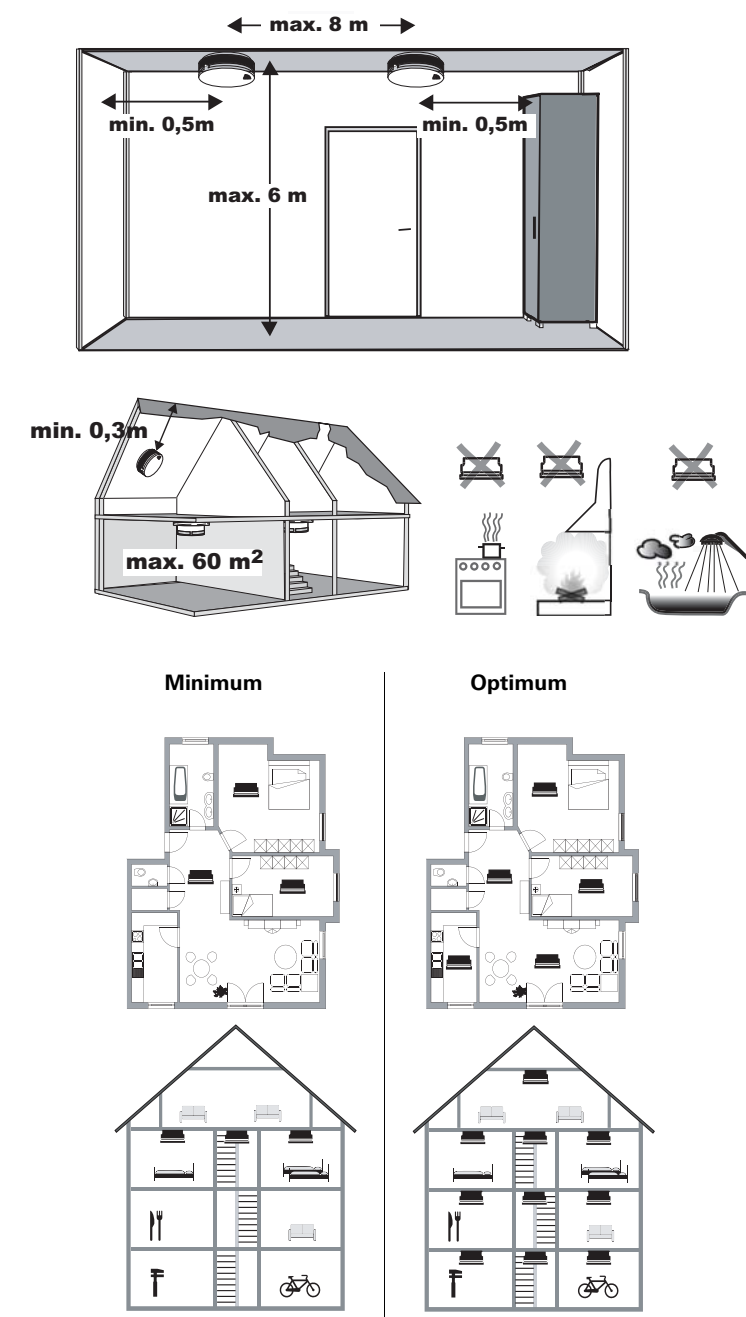

Verbinding met extra vrije ader in 230 V-net/
Ligação com um fio livre adicional na rede de 230 V

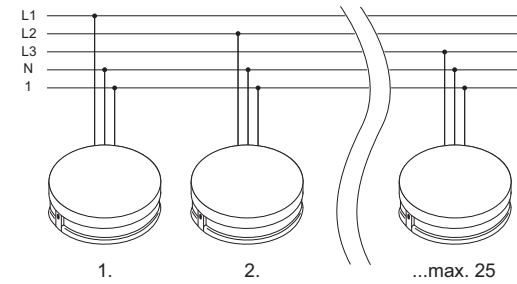

Combinatie verbinding met kabel en verbinding met RF /
Combinação ligação com cabo e ligação via rádio

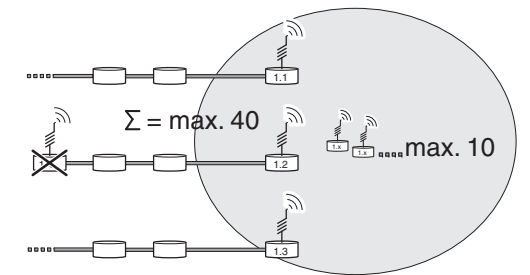

Verbinding met RF /
Ligação via rádio

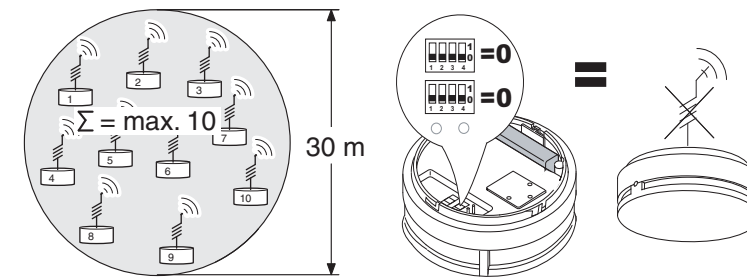

Verskillende groeps-ID's bij overlappende RF bereiken / Números de identificação de grupo diferentes em caso de sobreposição das áreas de alcance do rádio

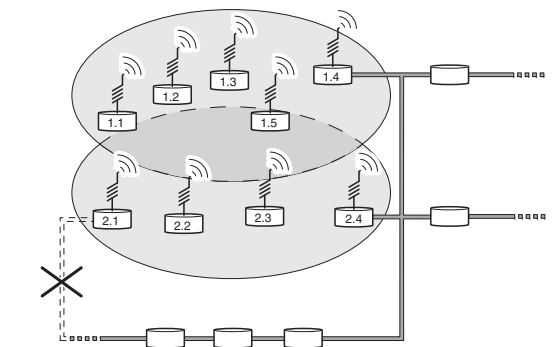
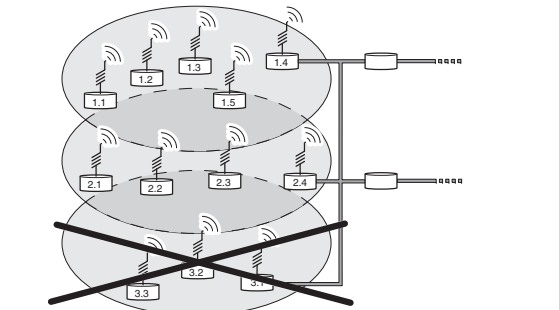

Functietest /
Teste de funcionamento

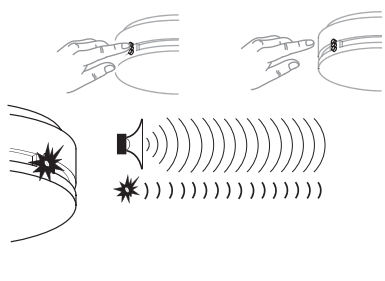

Vervanging van de batterij /
Substituição da pilha

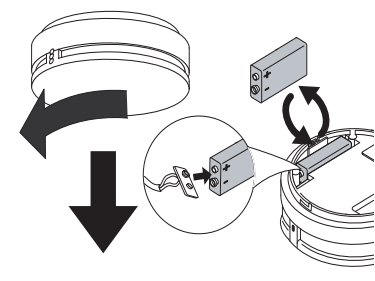

Merten GmbH
 Lösungen für intelligente Gebäude,
 Service Center, Fritz-Kotz-Straße 8,
 Industriegebiet Bomig-West,
 D-51674 Wiehl,
 Telefon: +49 2261 702-204,
 Telefax: +49 2261 702-136
 E-Mail: servicecenter@merten.de,
 Internet: www.merten.de
 InfoLine: Telefon: +49 1805 212581*
 oder +49 800 63783640,
 Telefax: +49 1805 212582*
 oder +49 800 63783630;
 *kostenpflichtig / fee required
 E-Mail: infoline@merten.de

